



PROJECT		REF		REV	ITEM CODE	
LOCATION		DATE			PAGE	

SANITARY WARE SPECIFICATION SHEET

Item Descriptions	Fluidmaster (USA) 1/2" Plastic float operated valve	Illustration/ Drawing 
Model	747UK	
Material	Plastic	
Manufacturer	Fluidmaster Inc	
Supplier	Acme Sanitary Ware Co. Ltd Mr. Eric Wong/ Mr. Don Yuen	
Contact Tel/Fax	(852) 2388-7171 / (852) 2710-8012	
E-mail	acme@acmesanitary.com.hk	
Website	www.acmesanitary.com.hk	

747 SERIES

The whisper quiet Fluidmaster 747 Series Fill Valve boasts a compact and modern design with a high critical level. The optional riser tube enables for a custom installation either by side mount or bottom mount at varying heights. The 747 works efficiently with high or low water pressure. The high level of accuracy provided by the valve makes for an ideal flush volume in any toilet. The durable parts stand up to years of flushes, while the narrow profile allows a proper fit in slim-line WC cisterns with no adjustment needed. Quality is assured by factory testing of every valve, living up to the highest Fluidmaster quality standards.

FEATURES

- Whisper quiet operation
- Compact size fits a wide range of applications including small in-wall tanks
- Unique self-cleaning valve mechanism operates from very low to high pressures
- Meets requirements of major codes around the world
- 3 Refill port locations
- Hand wash option available

STANDARDS COMPLIANCE



Note:

* All information of the above is for the reference only. No prior notice is made if any changes.

TECHNICAL DATA

- Operating pressure: 2.6-232 psi (.02 MPa - 1.6 MPa)
 Bowl refill rates: (see chart B)
 Critical Level: 1.4" (35.5 mm) (side mount) 2" (50.8 mm) (US)
 Sound level: 32 dBa with restrictor (side mount)
 Standard side mount thread configuration:
- 747UK (ISO 228-1 G 1/2 B) (plastic and brass)
 - 747E (ISO 228-1 G 3/8 B) (plastic and brass)
- Standard 15/16" plastic bottom mount riser tube heights:
- 7.76" (197 mm), 9.3" (236 mm), 9.6" (243 mm), and 10.8" (274 mm)
- Float adjustment range: 4.5" (114.3 mm)
 Footprint: 3.42" x 2.20" (86.8 mm x 55.9 mm)

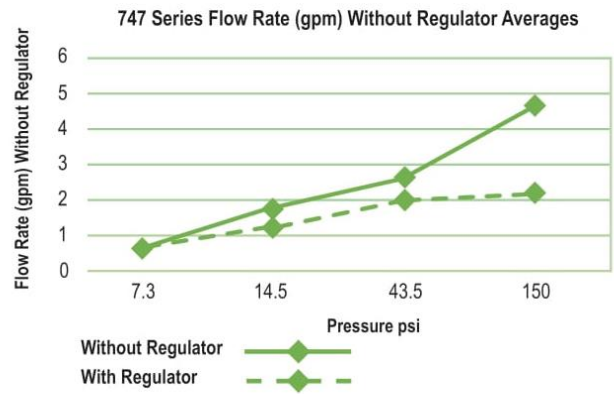

INSTALLATION GUIDELINES

- Recommended torque range:
- Plastic Bottom Mount Riser: 5-8 ft-lbs. (60-96 in-lbs.)
 - Side mount: varies by code requirement

B Bowl Refill Rates: 0-36%

	Standard Valve Down Tube	High Refill Down Tube
No Insert	33%	44%
Yellow	30%	41%
Blue	28%	38%
Natural	21%	30%
Green	20%	28%
Red	16%	24%
Orange	7%	12%

HOW TO SPECIFY (CODE APPROVAL REQUIRED)

- ✓ Bottom inlet or side inlet (A)
- ✓ Refill restrictor & percentage (0-44%) (B)
- ✓ Size of shank (3/8", 1/2", 15/16")
- ✓ Shank material (plastic, brass, nickel plated brass)
- ✓ Height of optional 15/16" riser (D)
- ✓ Height of float (E)
- ✓ Refill port positions (F)
- ✓ Shank washer installed
- ✓ Attachment parts and accessories

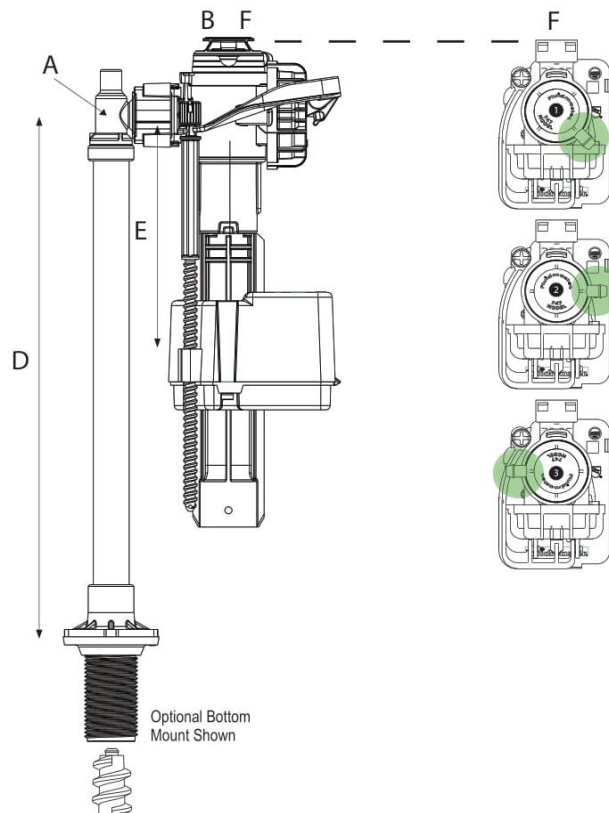

OPTIONS AND ACCESSORIES

- Flow restrictor option
- Locknut (purchase in bulk separately)
- Optional flow restrictor
- Refill restrictors
- Riser regulator
- Hand wash
- Multiple shank configurations

30800 Rancho Viejo Road
 San Juan Capistrano, CA 92675 U.S.A.
 (949) 728-2000 www.fluidmaster.com

TO GET THE BEST RESULTS FROM YOUR FLUIDMASTER VALVE,
 PLEASE READ THESE INSTRUCTIONS CAREFULLY.

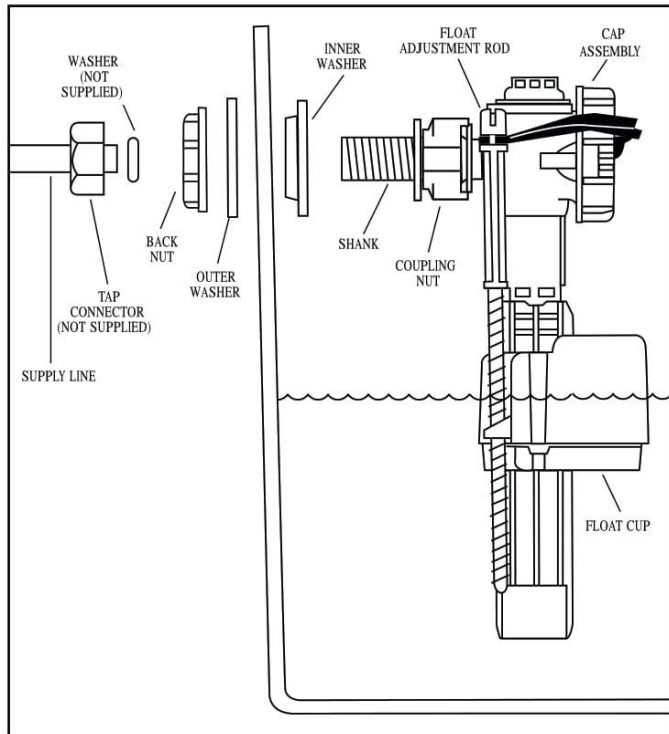

FLUIDMASTER 747UK SIDE INLET FLOAT VALVE INSTALLATION INSTRUCTIONS FOR TOILET CISTERN OR STORAGE TANK

NOTE: SAVE INSTRUCTION SHEET FOR FUTURE REFERENCE CONCERNING THIS VALVE'S OPERATION AND MAINTENANCE.

WARNING: Fluidmaster shall not be responsible or liable for any failure of, or damage to, this plumbing product caused by use of chlorine (bleach) cleaners or related products added to the tank water. Use of such products will void the warranty and may result in product failure, possibly causing property damage. Do not overtighten plastic nuts.



For more information in the U.K. contact:

Fluidmaster UK
 Twyford Road
 Rotherwas, Hereford, HR2 6JR
 Tel: 01432 357331
 Fax: 01432 264014
 E-MAIL: salesuk@fluidmaster.com
 WEB: www.fluidmasterUK.com

U.S. Patent No. 6,354,326 B1.
 Other U.S. and Foreign Patents Pending.

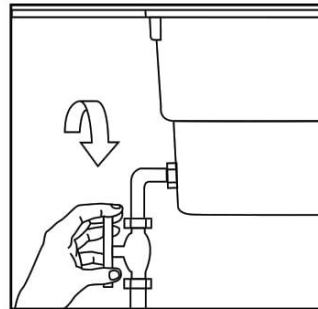

1. Turn off water supply.

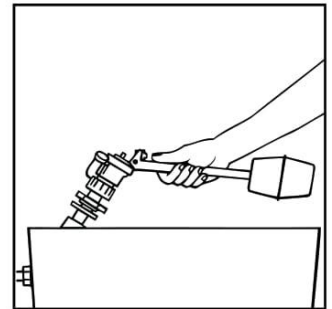

2. Disconnect pipe work and remove old valve.

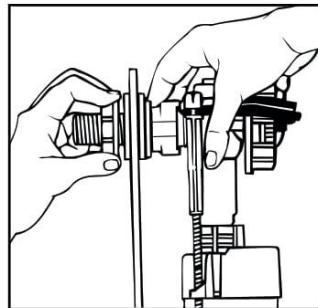

3. Place inner washer onto threaded shank then install new valve through cistern or tank hole. Place outer washer onto shank outside cistern or tank then thread back nut onto threaded shank to enable tap connector to fit neatly to avoid cross threading.

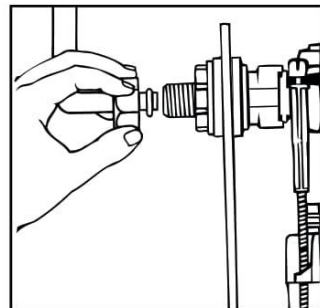

4. When position is correct, before tightening back nut, reconnect water supply to valve, making sure washer is seated correctly. Tighten tap connector 1/4 turn past hand tight with spanner (DO NOT OVERTIGHTEN). Now tighten back nut with spanner 1/4 turn past hand tight (DO NOT OVERTIGHTEN).

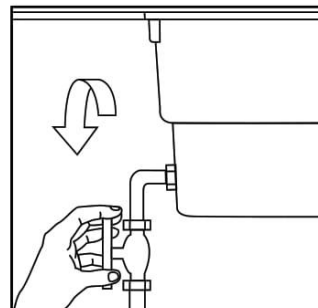

5. Turn on water supply.

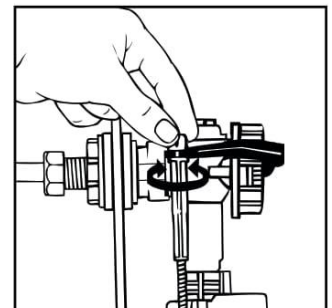

6. Adjust float until water level is as marked on inside of cistern or tank. If overflow pipe is at same level as supply line, adjust water level to approximately 25mm (1 inch) below overflow pipe. Turn float adjustment rod clockwise to raise and anti-clockwise to lower water level.

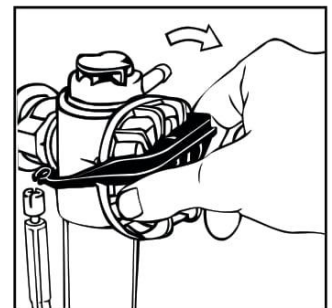
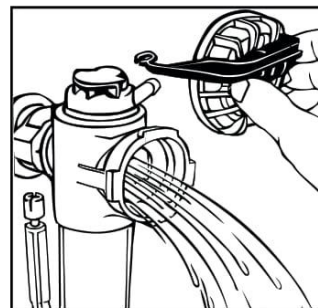
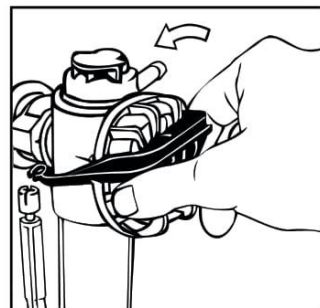
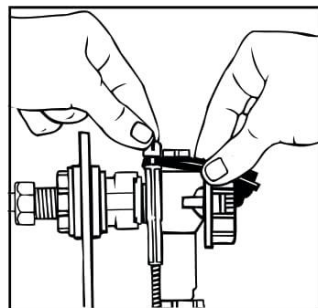

7. **IMPORTANT: ALWAYS CLEAR ANY DEBRIS FROM WATER LINE TO COMPLETE INSTALLATION.** Shut off water supply to toilet cistern or tank, unsnap float adjustment rod from arm, then remove cap assembly by rotating 1/8 turn anti-clockwise and pulling out. Hold hand over opening, turn water supply on and off to clear out debris that may be in supply line. Turn off water supply and replace cap assembly by engaging lugs and rotating 1/8 turn clockwise to stop. Make certain cap assembly and valve body are in locked position or valve may fail to turn on. Then snap float adjustment rod back on to the arm. Turn on water supply.

LOW PRESSURE APPLICATION: If it takes longer than 4 minutes to refill your cistern, you can increase the flow of water by removing the flow restrictor.
IMPORTANT: Always clear any debris from water line before installation.

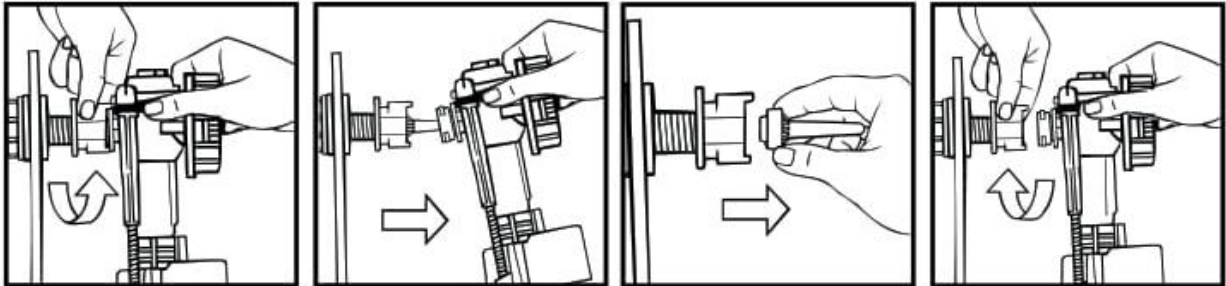

1. Turn off water supply and loosen coupling nut by rotating 1/8 turn until you hear a click.
2. Pull valve away from shank.
3. Remove flow restrictor located inside the shank.
4. Position valve onto shank, line up lugs and tighten coupling nut by rotating 1/8 turn until you hear a click. Turn on water supply.

TROUBLESHOOTING – SEAL REPLACEMENT. If valve won't turn on or shut off or refill of cistern water is slow after valve has been in use for some time, a replacement seal may be needed. Ask your dealer for Model 242MP071 and install as follows:

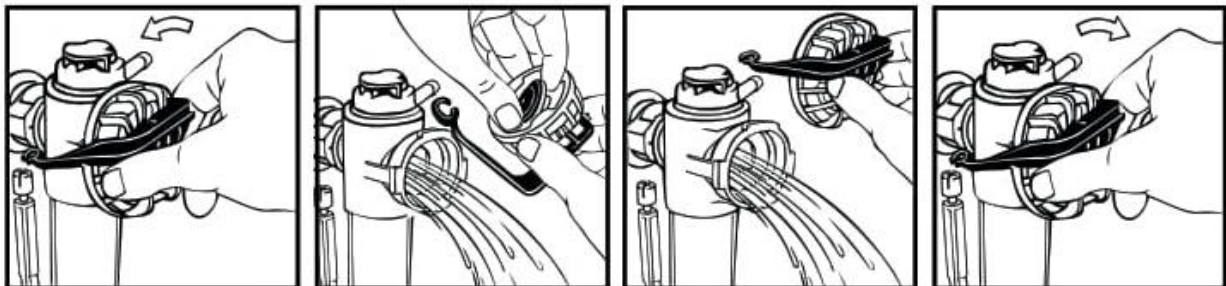

1. Turn off water, flush toilet. Unsnap float rod. Push in on side and remove assembly.
2. Remove seal, **do not bend stainless steel stem.** Replace seal, flat side up.
3. Hold hand over opening, turn water on and off to clear debris.
4. Engage lugs, be sure assembly is fully turned to stop and in locked position. Resnap float rod. Turn on water.



水務署
Water Supplies Department



總部 Headquarters

灣仔告士打道七號入境事務大樓 48 樓

Immigration Tower, 7 Gloucester Road, Wan Chai, Hong Kong

(2) in WSD 3321/2021 T/J(362/2021)

Our ref.
來函編號
Your ref.

電話 :
Tel. :
傳真 : 2824 0578
Fax.

23 March 2021



**Approval of “FLUIDMASTER” Float Operated Valve
(General Acceptance No. C20210308F)**

Your letter ref. D73A/2021/0132 dated 25 February 2021 refers.

Having considered the test report ref. J26093 issued on 23 February 2021 by Nutek Systems (HK) Limited, this Authority accepts that the fitting described below complies with, and its use when correctly installed does not contravene, the Waterworks Ordinance and Regulations.

Name of Manufacturer: Fluidmaster (Zhongshan) Plumbing Product Co Ltd

Country of Origin: the Mainland of China

Brand: Fluidmaster

Details of Fitting: 1/2" Plastic float operated valve

Model: 747UK

Body Markings: **Fluidmaster**

Expiry Date: 21 February 2026

Proviso: As the fitting has not been tested for use in contact with water intended for human consumption, the fitting can only be used in flushing water plumbing system.

This Authority hereby permits the use of the above fitting in flushing water plumbing systems subject to full adherence to Waterworks installation requirements. In particular, you are required to draw your customers' attention to the following requirement-

"The flushing volume of the flushing valve should be adjusted to suit the design of the toilet bowl so that wastes can be cleared effectively by a single flush."

"The fitting should be used within the range of working pressures specified by the manufacturer." AND

"The installed fitting should not result in backflow of water that will contaminate the flushing water supply."

A condition of this acceptance is that the fitting to be installed shall be replicas of the sample as certified by the testing agent mentioned above and without modifications. This acceptance may be withdrawn at any time if the standard of the fitting installed fails to meet that of the approved sample or if the fitting is found to be unsuitable for use in flushing water plumbing systems.

For the use of the fitting in any project, the General Acceptance Number of this letter must be quoted as a means of identification of acceptance of the fitting by this Authority.

Should you have any enquiries, please contact our Engineer Mr. Terry KUNG at tel. no. 3583 4086.

Yours faithfully,



(Roger WONG)

for Director of Water Supplies

Encl.

c.c. WSD 3321/1/82] - without catalogue
ME/MC] - with soft copy only